

BROBEIL MARINE SALES  
FRANCIS G. BROBEIL PAUL H. PROBETT  
1812 Niagara St. Buffalo 7, N.Y.  
Telephone DE 4-1560

# SHELL LAKE



# Boats



# SHELL LAKE CRAFT . . . Give You Safe, Speedy, Comfortable, Economical Water Transportation . . .

*( Over 45 years experience keeps Shell Lake Boats  
well ahead of the field in design and construction )*

**E**XAMINE a Shell Lake Boat carefully. Notice the clear, well seasoned material used, and the expert workmanship in both building and finishing operations. Step back and view the well proportioned depth, width, length and general shape.

Step into a Shell Lake Boat. Notice how steadily it rides, and how well it responds to the power of your outboard motor or a pair of oars. You have an immediate feeling of confidence that here is a hull that will take you there . . . and back . . . in absolute safety.

And back of every boat is their reputation for building good boats, for fair and honest dealings, and the guarantee of the Shell Lake Boat Company as to material and workmanship.

We wish to assure you that we are in no instance building a "price" boat to meet competition and respectfully solicit our business from you who are interested in a boat of high grade material, expert, experienced workmanship and proven design. In boats, as in any other type of merchandise, you get just what you pay for . . . no more and no less.

Relax on the wide, well placed seats. Notice the height from the floor which permits comfortable seating without cramping legs or body.

Shell Lake Boat design is the result of 45 years experience in boat building. The graceful lines and beautiful finish of these boats have not "just happened." They are the results of careful designing and painstaking effort and care in testing and perfecting each little detail.

## The SHELL LAKE Guarantee

**W**E GUARANTEE high grade workmanship in every detail of Shell Lake Boat and Canoe construction. All wood used is well seasoned and absolutely free from defect. All fastenings are either brass, copper, or cadmium plated. All hardware is heavily galvanized. All canvas covering is 18 oz., No. 8, Double Thread.

SHELL LAKE BOATS AND CANOES are guaranteed to be exactly as represented. If not satisfied you may return your Shell Lake Boat or Canoe to us within ten days after date of delivery and your money will be refunded promptly.

**SHELL LAKE BOAT COMPANY · SHELL LAKE, WISCONSIN**

Member: OUTBOARD BOAT MANUFACTURERS ASSOCIATION    Sustaining Member: OUTBOARD BOATING CLUB of AMERICA

# YOU GET EXTRA VALUE in Shell Lake Strip Boat Construction, Greater Strength, Better Service . . .

## SHELL LAKE STRIP CONSTRUCTION

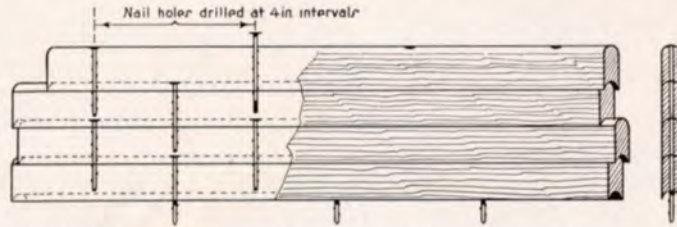

NOTE: This diagram shows how Shell Lake "Strip" construction reduces weight, makes stronger, water-tight boats.

### STRIP CONSTRUCTION

The descriptions of many of the boats in this catalog give special emphasis to Shell Lake Strip Boat Construction. This construction, illustrated in diagram above, is the reason Shell Lake Boats are lighter in weight, stronger, more water-tight, easier to clean, and easier to handle in the water. Strips of select, dry material, running the full length of the boat, are fastened together to form a smooth, continuous wall, with no overlaps and no protrusions.

Before assembling, each strip is run through a shaping machine which rounds one edge and hollows the other. When two or more strips are placed together they form a snug, water-tight fit. The strips are nailed through pin holes drilled by machines at four-inch intervals and staggered so that all but the gunwale and keel strips are actually fastened every two inches (see diagram). The nails are two inches long and specially processed to make them rustproof. Oak ribs, spaced close together, are fastened to the strip walls with cadmium plated, rustproof screws.

### MATERIALS

The material used in the hulls of Shell Lake Boats is all select, dry Western Red Cedar. Hulls are re-enforced with heavy oak keels on the outside, and in the larger models by oak keelsons inside. Heavy steam-bent oak ribs, spaced at 12 inch centers, brace the entire length of the boat. The bow is strengthened with heavy, steam-bent oak stems or bow pieces . . . one inside and one outside. The transoms or stern pieces are of mahogany, 1¼ inches thick, re-enforced with oak edges, and at the bottom center and top corners with heavy knee braces. On all models where heavy motors are recommended additional "V" braces are used. Gunwales are of mahogany and are riveted together through the top planking with copper rivets.

Seats are Western Red Cedar, Spruce or Pine, braced with our patented seat braces which are bolted to seats and gunwales.

Floor Racks or Bottom Racks are not necessary in Shell Lake Boats. Every model is built with half ribs between the full ribs, thus providing a permanent floor and adding a great amount of strength to the hull of the boat. The absence of floor racks eliminates a hiding place for tackle, bait or dirt that may be dropped into the bottom of the boat. Shell Lake Boats are very easy to keep clean and to paint or varnish.

All Hardware Items . . . screws, nails, rivets, braces, sockets and oarlocks are rust proof, and only the very best grades of Spar Varnishes and Marine Paints are used. Nothing has been overlooked in either the design or construction of Shell Lake Boats to give you the utmost in quality and value.

### MOTOR RECOMMENDATIONS

For each boat we have suggested the motor horsepower best suited to that particular model. Larger or smaller motors may be used, but the size we have recommended will, in most cases, give most satisfactory performance.

# CHEMISEAL . . . For the Protection of Shell Lake Boats

CHEMISEAL is an exclusive formulation containing a powerful fungicide (Phenyl Mercury Oleate Plus) together with a special combination of oils, gums and resins that completely penetrates wood.

CHEMISEAL controls decay, mold, mildew, stain, insects and the contraction and expansion in wood.

Most small boats must eventually be discarded because some one or more parts of them has decayed to the point where they will not hold together and are no longer safe to use. If the wood in a

boat could be kept completely dry or completely wet, it would not decay because completely dry wood does not have a sufficient amount of moisture, and completely wet wood excludes all air. A combination of moisture and air is necessary to cause decay.

Wood cannot be completely waterproofed by applying paint or varnish, consequently moisture is usually present in the wood in sufficient quantity to promote decay . . . thus, the only satisfactory and sure method to control decay is to poison the wood itself.

Every piece of wood used in a Shell Lake Boat has been immersed in CHEMISEAL and thoroughly impregnated. CHEMISEAL thus becomes a permanent part of the wood cell structure, and it cannot again be removed without destroying the wood itself. Neither soaking in water or exposing it to hot sun will leach out this powerful toxic from the wood.

The next important feature of CHEMISEAL, when used in small boats, is the control of expansion and contraction of wood. Expansion first, and then contraction of the strips or planking in a small boat is what causes seams to open up and allows water to leak in. The fungicide and preservative oils in CHEMISEAL remain in the pores of the wood, and, as long as the pores are filled with this solution, no water can enter. CHEMISEAL controls expansion and contraction from 50 to 75%. The treatment is unaffected by heat, cold, water, salt, sun and ultra-violet rays, and will not lose its protective qualities due to long weather exposure.

CHEMISEAL is the result of over nine years of experimental research and testing. It was specified and used by almost every division of the armed forces during the last war, and its use in small pleasure boats is being offered for the first time by us. It means longer life and more satisfactory service for Shell Lake Boats.

---

★

## METHOD USED IN MEASURING SHELL LAKE BOATS

**LENGTH:** Around outside Gunwale from Stem to Stern.

**HEIGHT FORE:** From bottom of Keel line to top of Deck Peak.

**INSIDE STERN:** From inside top of planking at lower edge of Transom, vertically to horizontal line level with top of Gunwales.

**INSIDE AMIDSHIP:** From inside top of planking vertically to a horizontal line level with top of Gunwales, midway between Bow and Stern.

**BEAM:** From outside Gunwale to outside Gunwale, inclusive, midway between Bow and Stern.

**WIDTH STERN:** Extreme width at Stern, including planking, but excluding "Splash Rails."

**LENGTH DECK:** From Bow to end of Deck, directly over Keel line. Transoms or Sterns are cut down to meet outboard motor recommendations of 15 inches.

# THE SCAMP (A Strip Boat)



**CHEMISEAL TREATED**



A semi-V type runabout: fast, dry and seaworthy for family use—beautiful in appearance and performance. Note the large, roomy cockpit and abundant seating

capacity. This is an exceptionally fast boat for its size and weight, yet absolutely safe and seaworthy under all conditions.

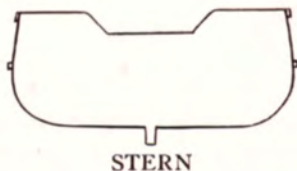

STERN

## SPECIFICATIONS

Model No.	Length	Height		Inside Depth		Beam	Width Stern	Length Deck	Approx. Weight
		Fore	Stern	Stern	Amidship				
14	14 ft.	26 in.	19 in.	21½ in.	56 in.	51 in.	60 in.	250 lbs.	
16	15 ft. 10 in.	26 in.	19 in.	21½ in.	56 in.	51 in.	60 in.	300 lbs.	

*Motor recommendations—9 to 55 h. p.*

*Steering Wheel with remote control, fully installed—\$40.00. Oarlocks included, Oars extra.*

## THE SCAMP (Continued)

The hull is equipped with full length, heavy Splash Rails which not only insure a dry boat at high speed, but also serve as a protective guard rail when docking.

The sixteen foot Scamp has two cross seats and "U" seat in stern as illustrated. All cross seats are equipped with Dinbec double action hinges on lazy-backs which open either fore or aft, or lie flat for rowing or to protect seat from rain or dew. The fourteen foot Scamp has two cross seats only, without "U" seat.

The planking is select, dry material, in strips  $\frac{1}{2}$  inch thick by  $1\frac{1}{8}$  inches wide, shaped and assembled as explained on page four,

and screwed to full length, steam-bent oak ribs  $1\frac{3}{8}$  inches wide by  $\frac{1}{2}$  inch thick, spaced 5-inch centers.

Deck is built up of matched mahogany strips approximately 3 inches wide laid over heavy oak cross beams, making a waterproof compartment under. Deck is faced with wide combing, and the rear cross member is extra heavy and wide, forming a dash to which steering wheel may be attached.

The inside of the boat, including deck and gunwales, is finished in natural wood and protected with three coats of best grade Bakelite Spar varnish. The outside of the hull is painted green below the splash rail and finished in natural wood above.



Fourteen-foot SCAMP carrying four passengers at thirty-five miles per hour

# THE CORMORANT (A semi-V bottom Runabout type . . . Strip construction.)

CHEMISEAL TREATED

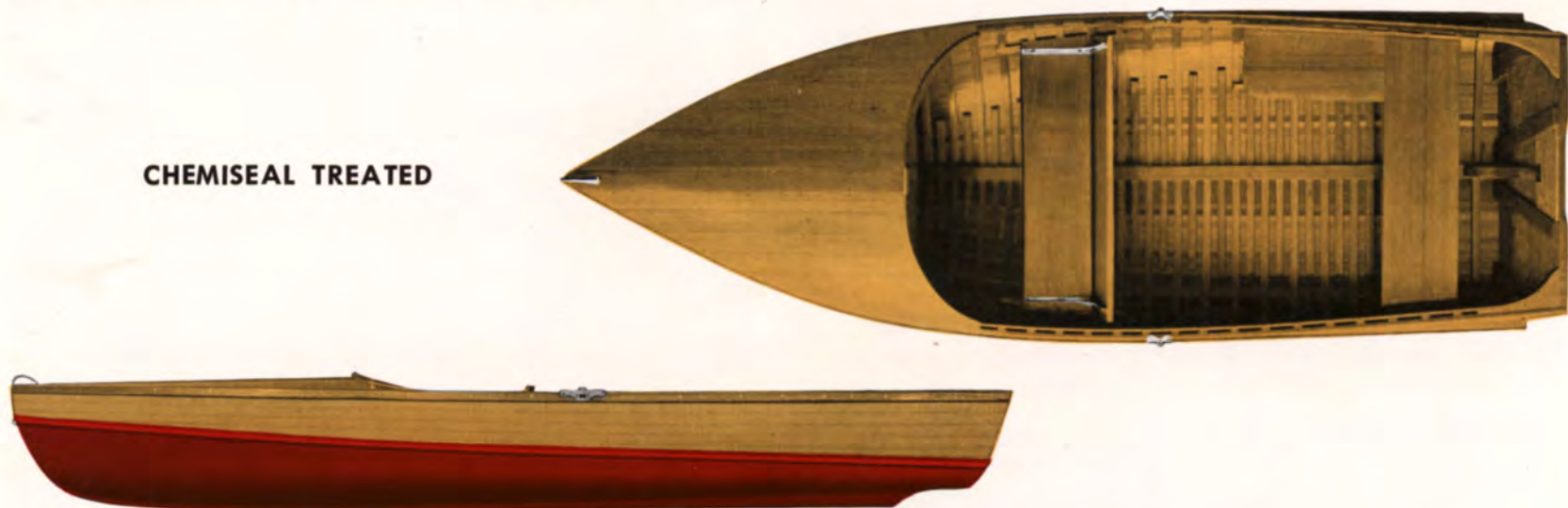

A fast-stepping little Runabout with less weight, beam and depth than our Scamp Model. Designed especially for speed and appearance, yet very sturdy and seaworthy. Its low bow gives it a "bullet" like appearance and heavy, full length splash rails keep the cockpit dry at high speed.

The planking is select, dry material in strips  $\frac{1}{2}$  inch thick by  $1\frac{1}{8}$  inches wide, shaped and assembled as explained on page four, and screwed to full length, steam-bent oak ribs  $1\frac{3}{8}$  inches wide by  $\frac{1}{2}$  inch thick, spaced 5-inch centers.

Deck is built up of matched mahogany strips approximately 3

inches wide, laid over heavy oak cross beams, making a waterproof compartment under. Deck is faced with a wide combing, and the rear cross beam is extra heavy and wide, forming dash to which steering wheel may be attached. Rear Seat is "L" shaped and front seat is equipped with lazy-back attached by means of Dinbec double action hinges which allows lazy-back to be used on either side of seat, or to fold flat over seat.

The inside of the boat, including deck and gunwales, is finished in natural wood and protected with three coats of best grade Spar varnish. The outside of the hull is painted bright red below the splash rail and finished in natural wood above.



STERN

Model  
No.  
24

Length  
14 ft.

Height  
Fore  
25 in.

Inside Depth  
Stern  
15 in.

Amidship  
19 $\frac{1}{2}$  in.

Beam  
53 in.

Width  
Stern  
48 $\frac{1}{2}$  in.

Length  
Deck  
60 in.

Approx.  
Weight  
225 lbs.

## SPECIFICATIONS

Motor recommendation—9 to 17 h. p.

Steering Wheel with remote control, fully installed—\$40.00. Oarlocks included, Oars extra.



# THE DE LUXE SCAMP and CORMORANT (Strip Boats)

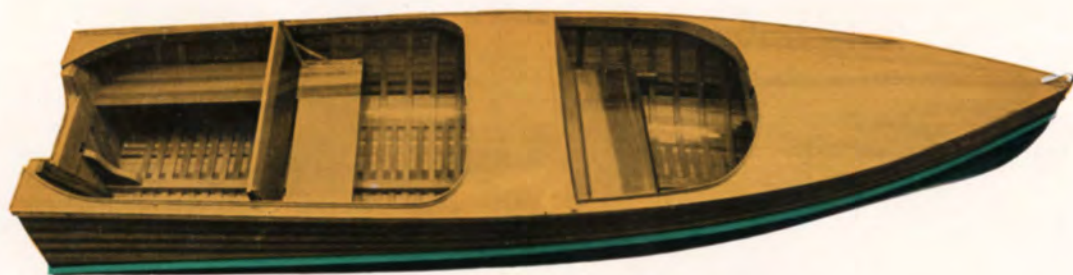

**CHEMISEAL TREATED**



These are our regular Scamp and Cormorant hulls, built with a double cockpit divided by a mahogany deck 15 inches long and crowned to match the forward deck, which is 60 inches long.

Gunwales are covered with mahogany, and both cockpits are completely surrounded by oak combing. Back rest in forward

cockpit is a permanent part of center deck. Dinbec double action hinges on back rest in rear cockpit.

These are beautiful appearing boats, especially when equipped with windshield and steering wheel, and we are proud to offer them as the "Kings" of the Shell Lake Line.

## **SPECIFICATIONS**

**DE LUXE SCAMP:** Same as our regular Scamp, except that the weight of the Model D-14 is 295 pounds and the Model D-16 is 335 pounds.

**DE LUXE CORMORANT:** Same as our regular Cormorant except that the weight of the Model D-24 is 260 pounds.

**STEERING WHEEL:** Completely installed in Rear Cockpit, \$40.00.

**WINDSHIELD:** Completely installed on either deck, \$25.00.



# THE SCOUT (A strip boat, deep sea model) for use on large bodies of water.)

**CHEMISEAL TREATED**



The Scout has been designed by us to serve the resort owner, and outing organizations which insist on a craft that will stand the most severe punishment—a craft to carry a large party over the roughest waters. Many of these boats are being used by the United States Department of Agriculture in their Biological Survey work and Forestry Service.

The boat is equipped with full length, heavy splash rails on the sides, and bilge keels on either side of the regular keel on the bottom of the boat to protect and strengthen the hull. The inside of the hull, including seats, decks and gunwales, finished in natural wood and protected with three coats of spar varnish, and the outside of the hull is painted green below the splash rails and white above.

The planking is select, dry material in strips. In the 14 and 16 foot Scouts the strips are  $\frac{1}{2}$  inch thick by  $1\frac{1}{8}$  inches wide, and in the 18 and 20 foot Scouts the strips are  $\frac{5}{8}$  inch thick by  $1\frac{1}{8}$  inches wide, shaped and assembled as explained on page four, and screwed

to full length, steam-bent oak ribs size  $1\frac{3}{8}$  inches wide by  $\frac{1}{2}$  inch thick, spaced 5-inch centers.

Transom is well braced for use with largest outboard motors.

## SPECIFICATIONS

Model No.	Length	Height Fore	Inside Depth		Beam	Width Stern	Length Deck	Approx. Weight
			Stern	Amidship				
34	14 ft.	28 $\frac{1}{2}$ in.	19 in.	22 $\frac{1}{2}$ in.	54 in.	51 in.	25 in.	245 lbs.
36	15 ft. 10 in.	29 in.	19 in.	22 $\frac{1}{2}$ in.	56 in.	51 in.	25 $\frac{1}{2}$ in.	300 lbs.
38	17 ft. 10 in.	30 in.	20 in.	22 $\frac{1}{2}$ in.	58 in.	50 in.	25 $\frac{1}{2}$ in.	375 lbs.
30	19 ft. 10 in.	33 in.	21 in.	25 in.	60 in.	51 in.	25 $\frac{1}{2}$ in.	420 lbs.

*Motor recommendations—No. 34—17 h. p.; No. 36—33 h. p.; No. 38—50 h. p.; No. 30—50 h. p.*

*Oarlocks included, Oars extra.*

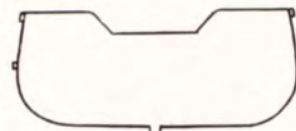

STERN

*Top left, 64 Fish Hawk; right, 54 Falcon; center, 52 Falcon; bottom left, 54 Falcon; right, De Luxe Cormorant.*

# THE FALCON (A semi-V type strip boat for all-around family and fishing use, wide, deep and comfortable.)

## CHEMISEAL TREATED

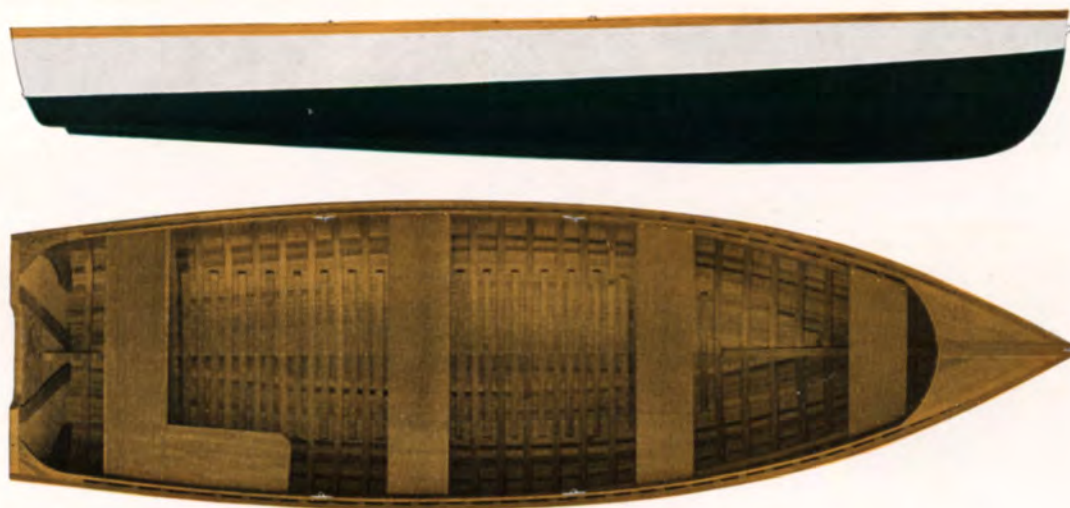

A wide, roomy semi-V type for use with motor and oars. Just the boat to run to and from the fishing grounds with, and to fish from while there. Note the full, flat floor, the liberal beam and depth amidship, all of which insures steadiness on the water and perfect safety in moving about in the boat. Very high speed can be obtained when used with large motors, and the design of the boat, with rocker keel, makes it plane and bank perfectly.

The outside of the boat is equipped with a heavy, full-length splash rail, and the hull is painted green below and white above this rail. The inside of the boat, including seats, deck and gunwales is finished in natural wood and protected with three coats of best grade Spar varnish.

The planking is select, dry material in strips  $\frac{1}{2}$  inch thick by  $1\frac{1}{8}$  inches wide, shaped and assembled as explained on page four, and screwed to full length, steam-bent oak ribs  $1\frac{3}{8}$  inches wide by  $\frac{1}{2}$  inch thick, spaced 5-inch centers.

The models 52 and 54 have two cross seats and "L" seat; the model 56 has three cross seats and "L" seat as illustrated. Transom is well re-enforced for use with large motors.

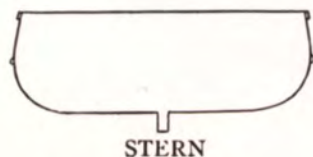

### SPECIFICATIONS

Model No.	Length	Height Fore	Inside Depth		Beam	Width Stern	Length Deck	Approx. Weight
			Stern	Amidship				
52	12 ft.	24 in.	14 $\frac{1}{2}$ in.	17 $\frac{3}{4}$ in.	50 in.	45 in.	23 in.	175 lbs.
54	14 ft.	25 in.	15 $\frac{1}{2}$ in.	18 in.	52 in.	45 in.	25 in.	200 lbs.
56	15 ft. 10 in.	26 in.	16 $\frac{1}{4}$ in.	19 $\frac{1}{2}$ in.	53 $\frac{1}{2}$ in.	44 in.	24 in.	240 lbs.

*Motor recommendation—No. 56—17 h. p., No. 54—10 h. p., No. 52—8 h. p. Oarlocks included, Oars extra.*

# THE FISH HAWK (Light, sturdy, smartly styled, a strip boat especially for resorts and rental service, but popular as a family boat.)

## CHEMISEAL TREATED

A well proportioned, strongly built boat for general use on lakes and rivers. A round bottom model with a flat floor, making it a boat very easy to row, and well suited for use with smaller outboard motors. The ideal boat for resort fleet, boat livery, or individual fishermen. The liberal depth of the Fish Hawk allows us to place the seats almost chair-height from the floor, making it a very comfortable boat to sit in for hours of fishing. The wedge shaped keel insures a true rowing course and adds steadiness to the boat.

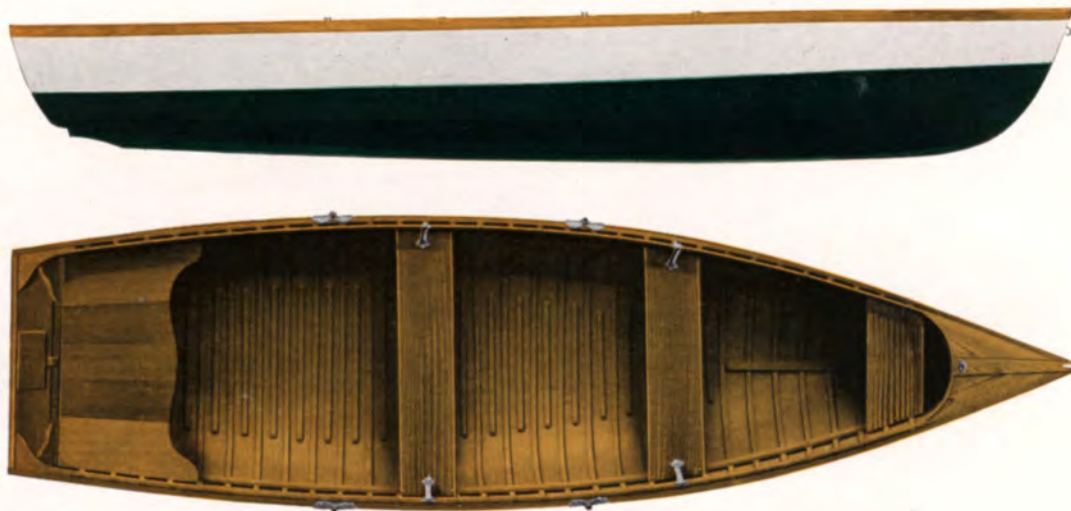

The outside of the hull is equipped with full length, light splash rails, and is painted marine green below and white above these rails.

The inside of the boat, including seats, deck and gunwales, is finished in natural wood and protected with three coats of best grade Spar varnish.

The planking is select, dry material in strips  $\frac{1}{2}$  inch thick by  $1\frac{1}{8}$  inches wide, shaped and assembled as explained on page four, and screwed to full length, steam-bent oak ribs  $\frac{7}{8}$  inches wide by  $\frac{1}{2}$  inch thick, spaced 5-inch centers.

### SPECIFICATIONS

Model No.	Length	Height Fore	Inside Depth			Width Stern	Length Deck	Approx. Weight
			Stern	Amidship	Beam			
64	14 ft.	24 $\frac{1}{2}$ in.	14 $\frac{1}{2}$ in.	18 in.	48 in.	36 $\frac{1}{2}$ in.	20 in.	150 lbs.
66	15 ft. 10 in.	25 in.	16 in.	19 in.	51 in.	37 in.	20 in.	180 lbs.

*Motor recommendation—3 to 8 h. p.  
Oarlocks included, Oars extra.*



STERN

# THE LADY GULL (An Outboard Cruiser: Strip Construction)



A daytime cruiser with full protection from rain or sun, recommended for four passengers for open water fishing or general pleasure use. Forward part of cockpit is enclosed with marine plywood—light in weight, yet very substantial. Two windows on both sides of cabin, and full, adjustable windshield forward provide ample vision and ventilation. Rear portion of cockpit left open for fair weather use. Boat is completely equipped with polished bronze cleats, chocks and running lights (no battery) and with steering wheel completely installed.

The planking is select, dry cedar in strips  $\frac{5}{8}$  inch thick by  $1\frac{1}{8}$  inches wide, shaped and assembled as explained on page four, and screwed to full length, steam-bent ribs  $1\frac{3}{8}$  inches wide by  $\frac{1}{2}$  inch thick, spaced 5-inch centers.

Deck is built up of matched mahogany laid over heavy oak beams, making a waterproof compartment under.

The inside of the boat is finished in natural wood and protected with three coats of best grade spar varnish. The outside is painted blue below the full length splash rails, and white above.

## SPECIFICATIONS

Model No.	Length	Height Fore	Inside Stern	Depth Amidship	Beam	Width Stern	Deck Length	Cabin Length	Approx. Weight
88	18 ft.	41 in.	20 in.	22 in.	61 in.	50 in.	60 in.	6 ft. 7 in.	550 lbs.

*Motor recommendation—10 to 35 h. p.*

## THE LADY GULL (Continued)

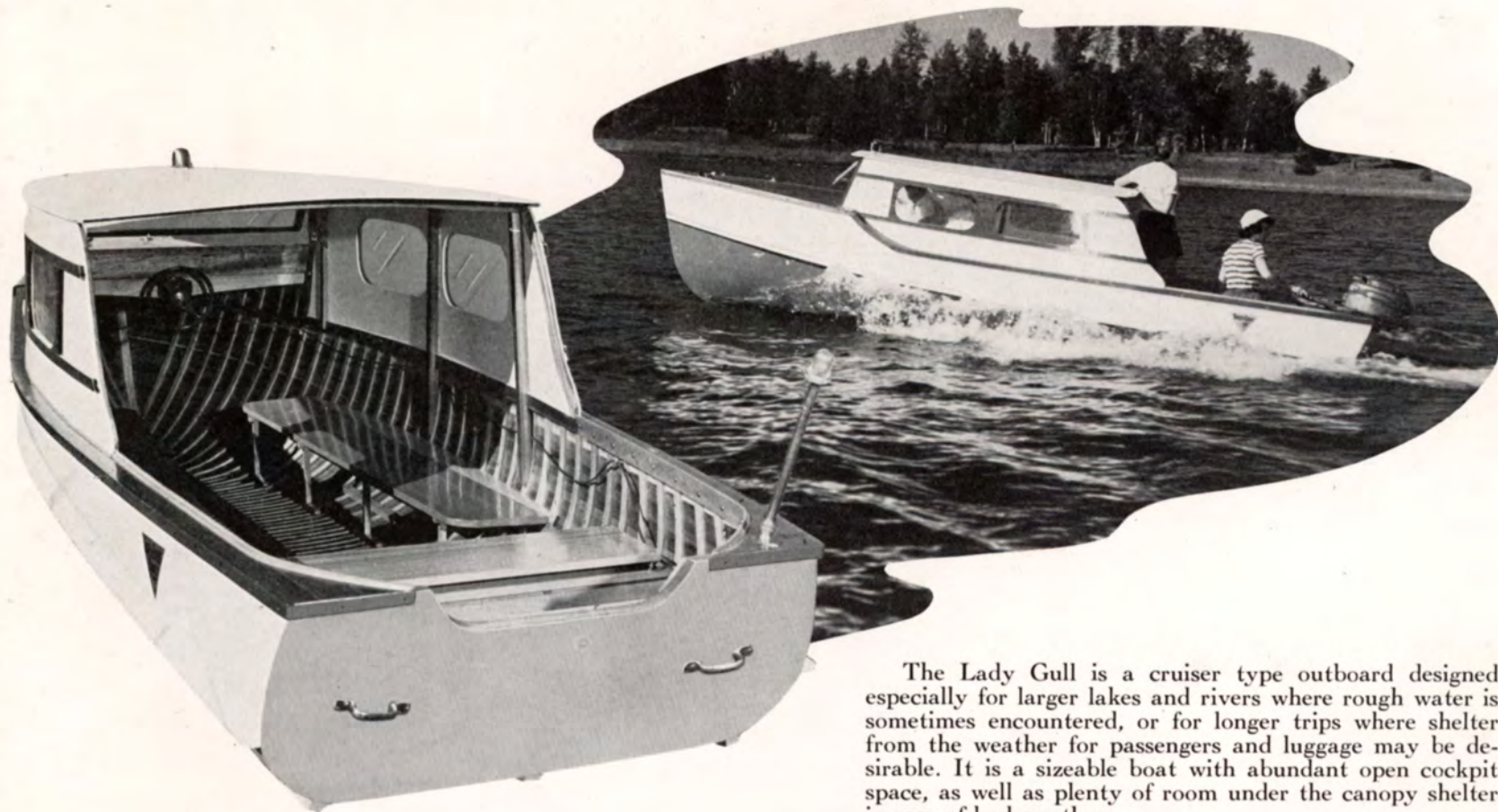

The Lady Gull is a cruiser type outboard designed especially for larger lakes and rivers where rough water is sometimes encountered, or for longer trips where shelter from the weather for passengers and luggage may be desirable. It is a sizeable boat with abundant open cockpit space, as well as plenty of room under the canopy shelter in case of bad weather.

With this model you can plan for an extended trip without worrying about packing your baggage too carefully for bad weather, or carrying a tarp for protection against rain and sun. It is a smart, snug, practical boat, strong and light, usable and comfortable under all conditions.

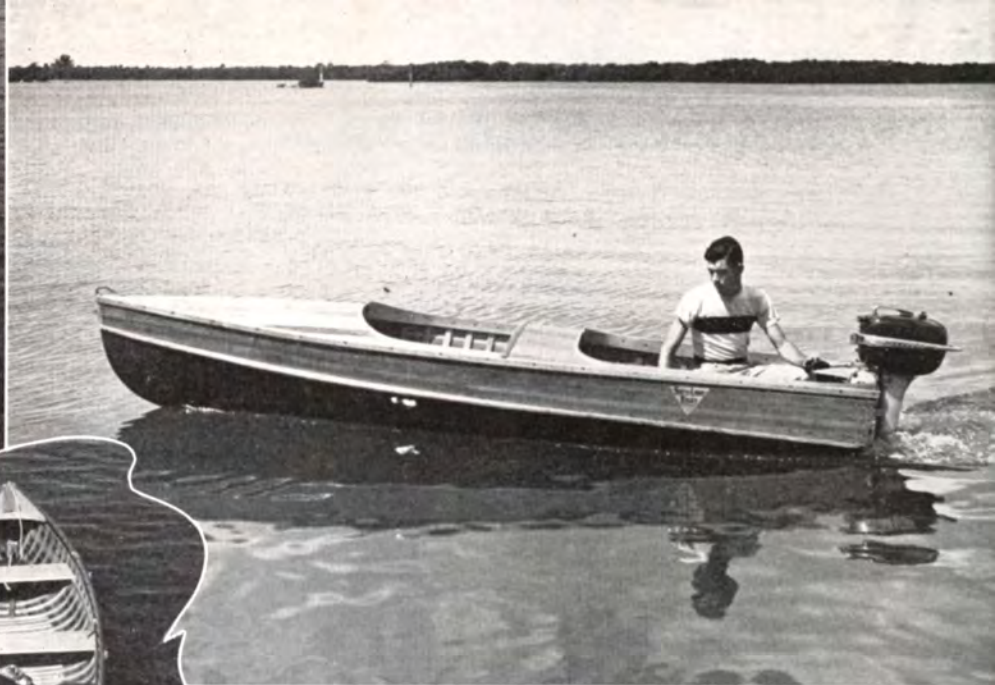



## CANVAS COVERED CRAFT



The following pages picture and describe our canvas covered models, including Canoes and Hunting Boats, and we wish to call your attention to the many advantages of canvas covered craft.

**FIRST:** The Leak-Proof feature found *only* in canvas covered hulls. No matter how long a canvas covered boat is left out of the water in hot, dry weather, there are no seams to open up and cause leaks when the boat is to be used. One piece canvas, stretched from gunwale to gunwale, and from bow to stern guarantee you a dry boat.

**SECOND:** Light weight yet sturdy, durable construction. By using heavy, well treated canvas, we are able to eliminate excess weight in the hulls and frame work.

Those of you who have never used a canvas covered boat, especially for hunting, may have the feeling that the canvas will

not withstand rocks, snags, or ice that may be encountered in your hunting waters. May we assure you that Shell Lake canvas covered boats and canoes due to the manner in which our canvas is stretched and treated, will withstand abuse from the above mentioned hazards as well, or better than any type of all-wood boat. This is especially true in paddling or poling through ice.

All canvas used on Shell Lake Canvas Covered Craft has been treated with CHEMISEAL for prevention of decay. It is practically impossible to thoroughly dry the inside of a canvas covered boat or canoe, consequently some moisture accumulates between the canvas and the planking or hull of the boat. This continuous damp condition usually starts decay in the canvas, causing it to deteriorate in a few years, and the only solution is an expensive, complete re-canvas job. By using CHEMISEAL TREATED CANVAS, we eliminate this one great objection to canvas covered boats and canoes.

# THE SNIPE (Canvas covered, a sturdy, canoe-type boat for outboards, with wide beam and high free-board and prow.)

CHEMISEAL TREATED

A beautiful, practical fishing and pleasure boat—light in weight yet very sturdy and seaworthy. Built of canoe type material and construction and with a canoe shaped prow. Has a generous beam and free-board, giving it a carrying capacity of from ten to twelve hundred pounds. A very popular model for auto-top or light trailer carrying from lake to lake.

Built with half-ribs through the entire length of the cockpit, giving a double floor to walk on, and a double bottom where the most wear and strain occurs.

Inside keel of clear oak,  $2\frac{1}{4}$  inches by  $\frac{3}{4}$  inches, plus oak closing strips over the ends of the half-ribs, gives the boat plenty of backbone for use with motors on rough water.

Outside keel of clear oak,  $\frac{7}{8}$  inch wide, and tapering from  $2\frac{1}{2}$  inches at the stern to 1 inch at the front, extends full length of the hull for bottom protection, stability, and ease in steering. Deck is strip type, of cedar or mahogany laid over heavy oak underbeams for strength. The 18-ounce canvas which covers the hull is laid in one piece from gunwale to gunwale, is triple filled and finished with three coats of best grade Spar enamel. Stock color green. The inside of the hull, including seats, deck and gunwales is finished in natural wood and protected with three coats of best grade Spar varnish. Boat is equipped with two sets of oarlock sockets for rowing. Stern and Bow are equipped with lifting handles.



Ribs, including half-ribs: white cedar,  $\frac{5}{16}$  in. x 2 in.

Planking: Western Red Cedar,  $\frac{3}{16}$  in. x  $3\frac{1}{8}$  in.

Transom: Mahogany or Oak,  $1\frac{1}{4}$  in. thick.

Inside and outside Keels, knee braces, inside Stems: Clear Oak.

Deck: White Cedar or Mahogany.

Gunwales: Mahogany, Spruce or Oak.

Seats: Western Red Cedar or Spruce.

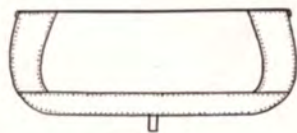

STERN

Model No.	Length	Height Fore	SPECIFICATIONS			Width Stern	Length Deck	Approx. Weight
			Inside Depth Stern	Amidship	Beam			
104	14 ft.	27 in.	15 in.	15 in.	45½ in.	41½ in.	28½ in.	115 lbs.

Motor recommendation— $2\frac{1}{2}$  to 8 h. p.

Oarlocks included, Oars extra. Splash Rails—\$12.00 extra.

# THE SNIPE JUNIOR (A lighter, canvas covered, canoe-type boat.)

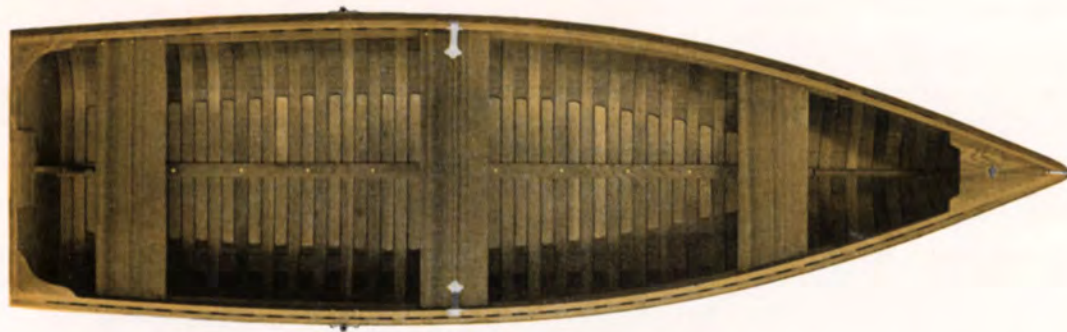

## CHEMISEAL TREATED

The Snipe Junior is a light weight, portage or auto-top model, designed for the fisherman who hauls or carries his boat from lake to lake, or from home to different lakes. Can be placed on or off auto top by one man yet is very seaworthy and has a carrying capacity of at least 800 pounds. Being canvas covered, the boat is always dry, no matter how long left out of the water.

Built of the same material and of the same type of construction as our regular Snipe, but designed to eliminate all excess weight by lowering and tapering the prow and forepart of the hull. The inside of the boat, including deck, seats and gunwales is finished in natural wood and protected with three coats of best grade Spar varnish. The outside of the boat is painted Marine Green or may be had in Dead Grass color for hunting. Stern and Bow are equipped with lifting handles.

### SPECIFICATIONS

Model No.	Length	Height Fore	Inside Depth		Beam	Width Stern	Length Deck	Approx. Weight
			Stern	Amidship				
103	15 ft.	17 in.	14½ in.	15½ in.	45 in.	39 in.	18 in.	90 lbs.

*Motor recommendation—5 h. p. or less.*

*Oarlocks included, Oars extra. Splash Rails—\$12.00 extra.*

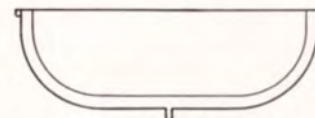

STERN



# SHELL LAKE CANOES (Built stronger than average with- out sacrificing beauty of line.)

CHEMISEAL TREATED

Shell Lake Canoes have proven their better value by popular demand from individuals, resorts, and the U. S. Government Forestry Service.

We and our friends have put Shell Lake Canoes to the hardest possible tests over a period of many years and we now feel confident that these fine canoes will give you more and better service than most other canoes on the market today, regardless of price.

Canoe building, like canoeing itself, is a cultivated art. Experienced canoeists will attest to the superior handling qualities and extra value in Shell Lake Canoes, and people not used to handling or riding in a canoe have no fears after a few minutes in a Shell Lake Canoe.

Although the De Luxe and Guide models are built of the same material, and to the same measurements, they are two distinct canoes, each in three lengths. The great difference in the two models is the double bottom, or half-ribs which are used in the De Luxe model but not in the Guide Model. This makes a difference of about ten pounds in the weight of the two models in the same length.

The De Luxe model, because of the double floor, is flatter on the bottom, rides a little higher on the water, is a little steadier and will carry a little more load than the Guide model. We recommend the De Luxe model in every instance where weight is not the important factor.



# SHELL LAKE CANOES (Continued)



## DE LUXE MODEL

Built with half-ribs through the entire exposed length of canoe, giving a double floor to walk on, and a double bottom where the most wear and strain occurs, thus adding many years of service to the craft.

## GUIDE MODEL

Built over the same mould and of the same material and to the same specifications as the De Luxe Model except that it does not have the double bottom, or half-ribs.

This is a very sturdy craft and one especially popular with guides, sportsmen and Forestry Service Employees where portages are necessary and weight is an important factor.

## MATERIALS

Planking: Select Cedar,  $\frac{3}{16}$  inch thick, steam placed in full lengths.

Ribs and Half Ribs: Clear White Cedar,  $\frac{5}{16}$  inch thick by 2 inches wide.

Gunwales: Open style of Mahogany.

Decks, Thwarts and Seat Frames: Mahogany or Oak.

Keel and Stems: Oak.

Canvas: 18 ounce Oceanic Duck, double filled and finished with two coats of flint-hard undercoater and two coats of best grade canoe enamel.

Inside of Canoe, including decks, thwarts, seats and gunwales, finished with three coats of best grade Spar varnish.

All fastenings of copper or brass.

Outside bows protected with brass or aluminum bands.

## SPECIFICATIONS OF DE LUXE AND GUIDE MODEL CANOES

Length	De Luxe Model			Guide Model		
	Beam	Depth	Weight	Model No.	Weight	Model No.
16 ft.	34 in.	12½ in.	80 lbs.	116	65 lbs.	1166
17 ft.	35 in.	12½ in.	85 lbs.	117	70 lbs.	1177
18 ft.	36 in.	12½ in.	90 lbs.	118	75 lbs.	1188

*Seventeen and eighteen foot canoes have five thwarts; sixteen foot length only four thwarts.  
Paddles, extra, \$3.50 each.*

# SHELL LAKE HUNTING BOATS (More real service, greater comfort, better transportation for hunters, anglers, trappers.)

You get light weight, with heavy boat strength.

You get safety . . . These boats will ride the waves or glide over marsh grass and boggy bottoms with perfect poise and steady keel.

You get small boat over-all dimensions, with big boat roominess. The insides are so arranged that there is convenient storage space for guns, rods, accessories, and duffle, and room to relax and move around with comfort.

You get easy handling, because of expert designing and light weight but sturdy construction.

You will get a real thrill in pride of ownership! You will find any one of these Shell Lake Hunting Boats a lasting source of genuine satisfaction on any wilderness trip, on any hunting, fishing or trapping expedition.

Study the construction details and specifications of these fine boats. Select the model best suited to your particular needs. These boats are hand-crafted by skilled workmen who do not know the meaning of "rush!" So, place your order early.

*Mallard Queen*



*Mallard Queen*



*Drake Mallard Towing Mallard Queen*



# THE MALLARD QUEEN (Canvas Covered)

CHEMISEAL TREATED



The Mallard Queen is positively sensational as a hunting, fishing or river boat, and well deserves the reputation it has of being the "slickest" little hunting boat on the market. Its light weight and flat, double bottom make passage over bogs and shallows easily possible in spite of its carrying capacity which is well over 500 pounds. Where heavier and longer boats are impractical for portages over crooked and timbered trails, these boats are ideal.

**MATERIAL**—Planking: Select Cedar,  $\frac{3}{16}$  inch thick. Ribs and half-ribs: White Cedar,  $\frac{5}{16}$  inch thick by 2 inches wide. Decks: Cedar, canvas covered. Keel and Stems: Oak. Combing:  $\frac{1}{8}$  inch oak re-enforced with oak half and quarter rounds. Canvas: 18 ounce Oceanic Duck, double filled. Color: Dead Grass, both inside and outside. Inside of cockpit fitted with ammunition or tackle racks. Fitted with handles at each end for carrying.

## SPECIFICATIONS

Model No.	Length Over-all	Depth, Inside Amidship	Beam	Cockpit Width	Cockpit Length	Approx. Weight
122	12 ft. 6 in.	13 in.	44 in.	30 in.	7 ft. 10 in.	75 lbs.

*Price includes two seats, one paddle, and oarlock blocks with sockets. Oarlocks included, Oars extra.*

### *Mallard Queens*

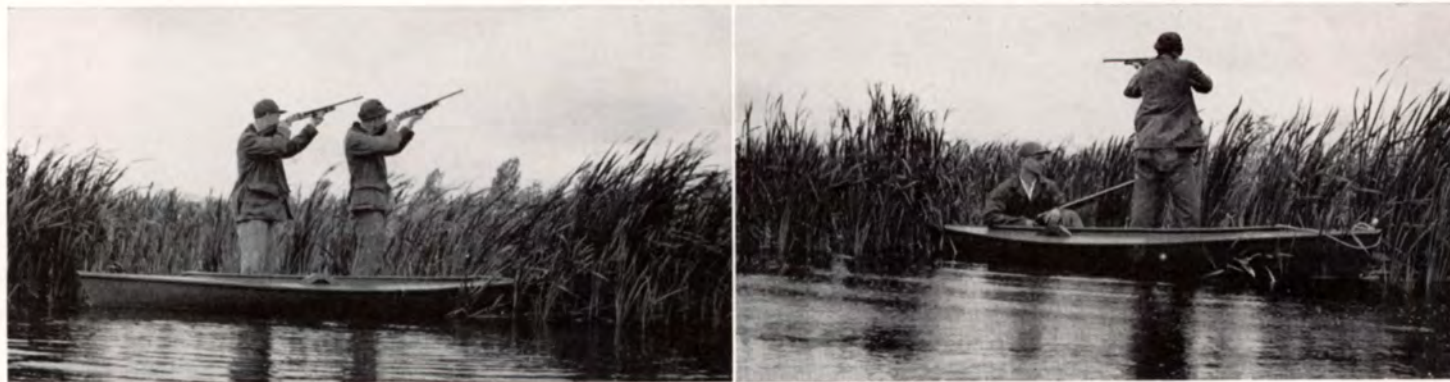

# THE DRAKE MALLARD (Canvas Covered)

## CHEMISEAL TREATED

The Drake Mallard is the companion boat to the Mallard Queen and designed in response to the many demands for a combination hunting and fishing boat adapted to the use of an outboard motor. Note the large roomy cockpit, and flat, double-bottom floor. A very practical, seaworthy boat to be carried on trailer or car top for use on either lake or river.

The same kind and weight material is used in the Drake Mallard as in the Mallard Queen, the Drake being augmented with an inside keel to which the transom or stern is braced with an oak knee-brace. The transom is one-piece oak or mahogany. The entire boat is painted Dead Grass color.

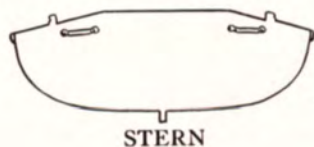

## SPECIFICATIONS

Model No.	Length	Height Fore	Stern Inside	Amidship Depth	Beam	Width Stern	Length Cockpit	Width Cockpit	Approx. Weight
133	13 ft.	17 in.	14 in.	14 in.	46½ in.	39 in.	9 ft. 8 in.	34 in.	100 lbs.

*Price includes Oarlocks, Oarlock Blocks and sockets, Oars extra. Motor recommendation—2½ to 5 h. p.*





# THE HUNTER AND TRAPPER (Canvas Covered)



## CHEMISEAL TREATED

To meet the demands for a boat that can be easily handled on and off car top, or over portages by one man, we have designed the Hunter and Trapper. It has the carrying capacity of our Mallard Queen, but is built up at the ends so that its general appearance is more that of a canoe. The material is of the same type and weight as in our other canvas covered models, but by using canoe type gunwales, short oak decks and but one thwart, we have been able to keep the weight of the finished boat down to what one man can handle with ease.

As a special feature we equip the Hunter and Trapper with four detachable rubber suction cups, two on each gunwale, which serve as carriers for use on car tops. Also, we have shaped the center thwart of the boat like a canoe yoke and, as standard equipment, we furnish two upholstered shoulder pads that may be attached to the yoke with thumb screws, thus enabling one man to carry the boat with ease.

## SPECIFICATIONS

Model No.	Length Over-all	Depth Amidship	Height at Ends	Beam	Approx. Weight
152	12 ft. 6 in.	12 $\frac{3}{4}$ in.	18 in.	42 $\frac{1}{2}$ in.	55 lbs.

*Price includes one light paddle.*

# SHELL LAKE BOAT ACCESSORIES (Convenient, Dependable)



**CANOE YOKES**

Light weight, but very strong. Yoke is made of clear, strong oak. Large, well upholstered shoulder pads relieve the strain on shoulders and neck when negotiating long portages.

Price each, complete with bolts.....\$4.00



**CANVAS BOAT COVERS, MILDEW AND WATERPROOF**

Made of heavy, Vivatex Treated Canvas, pre-shrunk to insure a minimum of shrinkage. A good boat cover adds years to the life of your boat. Prices complete with fasteners and tightening ropes.

Price for Boats:

Models 24, 52, 54, 64, 103 and 104.....	each, \$18.00
Models 14 and 34.....	each, 20.00
Models 56 and 66.....	each, 22.00
Models 16 and 35.....	each, 23.00
Model 38.....	each, 26.00
Model 30.....	each, 29.00

*All prices for accessories and material are f.o.b. factory. Shipment will be made by express, collect.*



**CANOE PADDLES**

Canoe Paddles: Spruce or Maple, varnished, 4½, 5 and 5½ ft. lengths.....each, \$3.50

Duck Boat Paddles, painted Dead Grass, 5 ft. length.....each, 2.50



**BOAT OARS**

(First Grade Oars, Varnished)

6 ft., per pair.....	\$7.00
6½ ft., per pair.....	7.50
7 ft., per pair.....	8.00
7½ ft., per pair.....	8.50

**OARLOCKS**

Pinned type, horns only.....per pair, \$0.75

**MARINE PAINTS AND VARNISHES, SMALL BOAT**

Green.....	per qt., \$2.00
White.....	per qt., 2.00
Vermilion.....	per qt., 2.00
Maroon.....	per qt., 2.00
Dead Grass.....	per qt., 2.00
Spar Varnish.....	per qt., 2.00
WHITE LEAD seam filler or putty.....	per lb., 0.75
CANOE ENAMEL, best grade, green or bright red.....	per qt., 2.50

# SHELL LAKE BOAT ACCESSORIES (Convenient, Dependable)

## DINBEC "DOUBLE-JOINTED" HINGES FOLD EITHER WAY

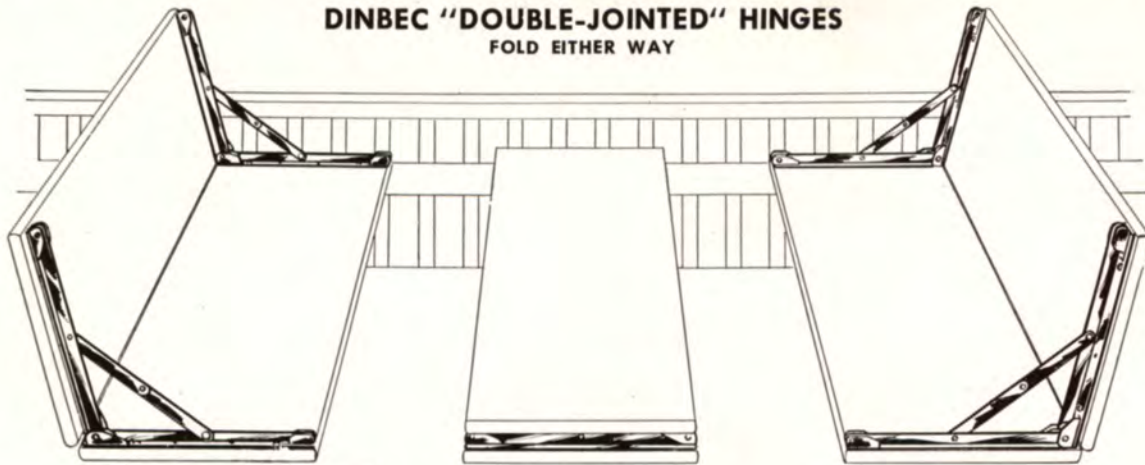

Standard equipment on Scamp and Cormorant boats and can be furnished as special equipment on other models, if desired. Add restful comfort and make it no longer necessary to sit in a cramped position no matter which way one faces for sightseeing or fishing. Easily folded to face either front or back of boat. When back is closed the seat becomes conventional, for rowing, to facilitate moving from one end of the boat to the other, or when the boat is tilted for draining or storing. In this horizontal position it covers the seat protecting it against rain or dew.

Hinges are sturdily constructed of steel, cadmium plated, and without adjustments to need attention. Installation is extremely simple, requiring only the addition of a board 12 inches wide or two six inch boards for the back, which are bolted to the Dinbec hinges. Will fit any size seat in any boat. Price each \$4.95 per pair.



### NO. 3 SWIVEL BOAT SEAT Ball Bearing

Clamps on seat of boat. Inlaid cork seat. Folds flat. Weight 12 lbs.....list, \$7.00



### NO. 2 BOAT SEAT

All steel. Weight 8 lbs. Inlaid cork seat. Folds flat.....list, \$4.50

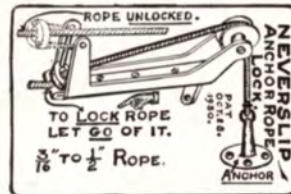

### "NEVER SLIP" ANCHOR ROPE PULLEY

Self-locking.....each, \$2.00

### BOAT ANCHORS

Mushroom type, 15 lb.....each, \$3.50



### FOX ANCHOR LIFT

Self-locking.....each, \$5.95  
Deck Model Anchor Lift, each.....\$6.95

*All prices for accessories and material are f.o.b. factory. Shipment will be made by express, collect.*

SHELL LAKE BOAT CO., INC.

SHELL LAKE, WISCONSIN

*Builders of Better Boats Since 1897*

**BROBEIL MARINE SALES**  
FRANCIS G. BROBEIL    PAUL H. BROBEIL  
1812 Niagara St.    Buffalo 7, N.Y.  
Telephone: DE laware 1560

